

Thank heavens there's no practicality tax.



If there was, can you imagine how much a Range Rover would cost? After all, few things on earth are more practical.

Range Rover has a 3.9 litre V8 engine which can move five people and their luggage effortlessly.

A viscous coupling unit which provides the most efficient form of four-wheel drive.

Alloy body panels which can't rust. ABS brakes which can't lock up. And a box-section chassis, which can't be beaten.

All of which makes a very strong case for rushing out and buying a Range Rover.

Because, for all practical purposes, it's tax free.



RANGE ROVER

FOR FURTHER INFORMATION OR FOR THE NAME OF YOUR NEAREST DEALER, PHONE SYDNEY 908 0822, OUTSIDE SYDNEY 008 252 022 (FREE CALL).

ULR ♦ LANDROVER WANDIN PARK HORSE TRIALS

WANDIN PARK ASSOCIATION

Box 705 Lilydale, Victoria 3140

President: Mr Russell Withers 544 2722 (B)

Secretary: Mrs Glenys Clark (059) 643 871

Country Fair Enquiries: Mr Dennis Conway (059) 643 200 (P)

TIME TABLE OF EVENTS

SATURDAY 10TH NOVEMBER, 1990

8.30- 3.00 pm	Restricted Novice Dressage. Ring 1 - 5	1.00 - 3.00pm	Young Eevnt Horse Trophy. Movement in Hand. Main Arena
8.30- 1.30pm	Novice Dressage. Ring 6 - 7		
8.30 -4.00pm	Advanced Dressage. Ring 8		
9.00 -12.40pm	Young Event Horse Trophy. Dressage and Showjumping. Main Arena	Please Note:	The top eight horses in the Young Event Horse Trophy will compete on Sunday to determine final placegetters

SUNDAY 11TH NOVEMBER, 1990

MAIN ARENA PROGRAM

10.30 - 11.45am	Young Event Horse Trophy. Dressage and Showjumping test
12.00- 12.15pm	Dressage to Music - Charlotte Pedersen and Carillo
12.15 - 1.00pm	Pony Club Team Games Championship
12.50 - 1.45pm	Novice Showjumping Section 1
1.40 - 1.50pm	Dressage to Music - Charlotte Pedersen and Carillo
1.50 - 2.30pm	Novice Showjumping Section 2
2.30 - 2.40pm	Young Event Horse Trophy - Movement in hand
2.40pm	Sky Divers
2.40 - 2.45pm	Carlton Clydesdale Team
2.45 - 3.00pm	Shetland Grand National
3.00 - 3.40pm	Range Rover/Horse and Buggy Challenge
3.40 - 4.00pm	Young Event Horse Trophy - Final judging by Capt. Mark Phillips
4.00 - 4.30pm	Advanced Showjumping
4.30 - 5.00pm	Tent Pegging Teams Event
5.00pm	Presentation of prizes

CROSS COUNTRY COURSE

8.45 - 1.00pm	Cross Country Restricted Novice
1.00 - 1.15pm	Cross Country Runners
1.30 - 2.40pm	Cross Country Advanced
2.40 - 3.00pm	Parade of Yarra Glen and Lilydale Horse and Hounds
2.40 - 3.00pm	Retriever Dog Display at Lake
3.00 - 4.09pm	Cross Country Novice

ALL DAY

*City of Dandenong Band

*Cobb & Co. Coach rides to the Quarry

*Range Rover courtesy vehicles are able to take
you on tour of the Cross Country Course

SHOWJUMPING ARENA NUMBER 2

9.00 - 10.00am	Restricted Novice Course walk - All Sects.
10.00-11.00am	Restricted Novice Showjumping - Sect. 1
11.00 - 12.00	Restricted Novice Showjumping - Sect. 2
12.00 - 1.00pm	Restricted Novice Showjumping - Sect. 3
1.00 - 2.00pm	Restricted Novice Showjumping - Sect. 4
2.00 - 3.00pm	Restricted Novice Showjumping - Sect. 5

SPECIAL ATTRACTION

Freestyle Skiing Aerial Display - Located close to the
Watering Hole Advanced Jump - opposite side of road.

PRIZES

	ADVANCED	NOVICE	RESTRICTED NOVICE
1st	\$1,000 plus rug & Brokeford Park Holsteiner Filly	\$350 plus rug	\$150 plus rug
2nd	\$800	\$250	\$125
3rd	\$600	\$150	\$100
4th	\$400	\$100	\$80
5th	\$200	\$80	Trophy
6th	\$100	\$70	Trophy

Rosettes to all placegetters

BROKEFORD PARK

Brokeford Park is proud to donate a yearling Holsteiner filly, Brokeford Park Darcy.

Brokeford Park Darcy is a bay filly by the 17.1hh Holsteiner stallion Siegfried out of Brokeford Park Jubilee.
Brokeford Park Jubilee combines the bloodlines of Romedio and the Thoroughbred Count Martial, an unbeatable
combination in any book. Brokeford Park breeds with six stallions and forty select Thoroughbred & Holsteiner mares.

They have young stock up to four years available for sale.

Enquiries telephone: (059) 976 354



FOR ALL YOUR
INSURANCE NEEDS...

AMP

BILL WALSH

5639000

SPECIAL ATTRACTIONS

Main Arena Commentary - Hugh Coleby
Main Arena Stewards - John Grant and Tony Reed

Pony Club Team Games Championships:

There is plenty of action to be seen when the teams from Lilydale, Yarra Glen, Donvale, Lower Plenty and Wyena compete for the Noble Perpetual Trophy. There will be four races - Bending, Flag and Barrel, Bat and Relay and Ride and Lead. These are the five finalists of competitions between Pony Clubs around the zone. Action starts at 12.15 pm in the main arena.

Dressage Display:

Spectators are in for a real treat when Charlotte Pedesen and her Palomino gelding, Carillo, combine to do a display of dressage to music.

Carillo, a ten year old, has been 'Elementary Horse of the Year', won the Medium Championship at Werribee and is now competing at Advanced level.

Charlotte originally from Denmark is now training horses and riders at the Glen-Brae Equestrian Centre at Wandin. Commentary will be by Jill Sinclair.

Cross Country Runners:

A popular event each year at Wandin Park is the race around the Restricted Novice Cross Country course by members of the Victorian Cross Country League. Over the jumps and through the water - whatever the horses do, so do the cross country runners. The race starts at the Cross Country start at 12.35 immediately following the Restricted Novice horses.

Saddle-Up - Wandin Park Young Event Horse Trophy:

This is our event to encourage breeders and trainers developing event horse of the future. The details of the competition are completely covered on the next page, but competitors are judged in sections covering dressage, jumping, conformation and a show of paces. Initial judging takes place on Saturday with the top eight horses being presented in the final competition on Sunday. This event is conducted throughout the day in the main arena.

Carlton Clydesdales:

These famous 'gentle giants' of the equestrian world are under the guidance of Australia's Four in Hand Champion, Mike Thill, assisted by Jim Portz and Glen Pate. The Carlton Clydesdales are famous throughout Australia and it's an honour to have them at Wandin Park. Keep an eye out for them around 2.40pm.

7-Eleven Shetland Grand National:

A hotly contested race for our young riders on their Shetland ponies. Months of training go into the preparation of these horses. The jumps consist of hay bales and the 'race track' is around the main arena. Come and see the action at 2.45pm.

City of Dandenong Band:

For your enjoyment the band will be playing throughout the afternoon adjacent to the Country Fair.

Sky Divers:

At 2.40pm four members of the Victorian Parachute Council will be jumping from 4000ft. and free falling to 2500 ft. during which time they will reach a speed of 160kmh. The lead parachutists will carry smoke flares and they will make their landing in the main arena.

Freestyle Skiing Aerial Show:

A little unusual for Horse Trials - but just across the road from the Advanced fence, the Watering Hole, is the largest artificial ski jump in the world. Throughout the day there will be non-stop action with some of Australia's best skiers, including Kirstie Marshall. The skiers wear regular skis and ski boots as they run down the synthetic slope, complete their aerials and land in the lake at the bottom of the run. Not for the faint hearted!

Retriever Dog Displays:

Following the Advanced Cross Country members of the K.C.C. and their dogs will put on a "non-slip retrieving display" at the Land Rover Lake. Watch these superbly trained dogs retrieve their 'quarry' from the water.

Yarra Glen & Lilydale Hunt Club Parade of Horses & Hounds:

The club currently run 40 coupies (80) of English Foxhounds based at their property in Yering. The club began in 1900 and currently has a membership of 120. Working the hound today, are members of the club led by Joint Masters Dr. J.C.C. Macaulay and S.R. (Dick) Oliver together with Nick Boulton from Scotland.

Personality Range Rover/Horse and Buggy Challenge:

Time for a little fun with our 'personalities' as we see them compete in a 'horseless carriage' against 'horse drawn carriage'. The event is designed to see which form of transport is quickest through the cones in this precision driving competition. Our celebrities will be in the Range Rover and members of the Yarra Valley Harness Club will be in the Buggy.

Tentpegging:

In the main arena at 4.30 pm four teams from Yea, Central Horsemen's Association, Nanneela Iseki and Nanneela Greys will compete in the spectacular sport of Tentpegging. Tentpegging has its origins in the Boer War where an army would ride up to the enemy camp at night spearing the tent pegs causing the tents to collapse. The enemy would be trapped and easy prey for the infantry. Tentpegging is a combat tactic sport which requires military drill and precision.

Presentations:

The winners and placegetters for all sections come together for a mounted presentation in the main arena at approximately 5.00pm. A spectacular conclusion to a busy day.



SUPASTOP Summer Collection

Summer is a breeze with a 'Supastop' rug from SaddleUp in our special summer weight, tear resistant material designed for horse rugs.

Supastop Summer Rugs feature Generous tail flap Darted and shaped to ensure a correct fit. Web leg straps and hood D's

Available in
Proofed Blue - \$68
or Natural White - \$58

Neck rugs and hoods, satin lined,
also available

Neck Rugs: Proofed Blue - \$ 50
Natural White - \$45

Hoods: Proofed Blue - \$55
Natural White - \$50

Let your horse look great,
feel comfortable
all through summer
with a Supastop from

SADDLEUP
*The Saddlery Store
that's got it all...*

403 - 405 Maroondah Hwy,
Ringwood, 3134.
Ph: (03) 870 1146 or 870 9607
Saddle-Up is proud to be
the sponsor of KATE WILSON

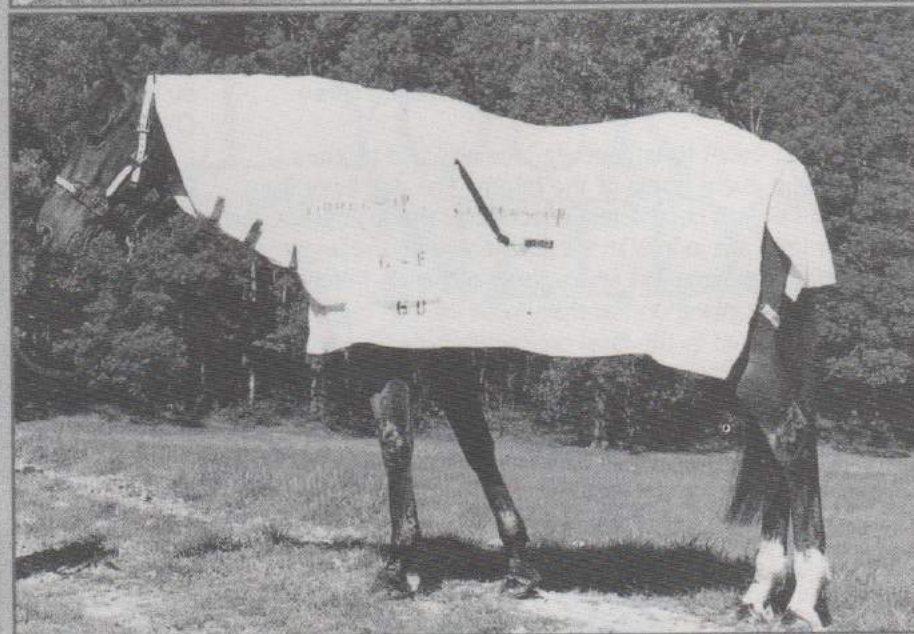

NOVEMBER SPECIALS

From England - the Cottage Craft
International Head-collar
In Pony, Cob or Full size.
Blue and silver - Black and red
\$37.50

**MAIL ORDER
WELCOME**

From the United States -
the Johnson Head-collar
Cob or Full
\$32



THE SADDLE - UP WANDIN PARK YOUNG EVENT HORSE TROPHY

First introduced to Wandin Park last year, this event has been run successfully throughout the U.K., with the finals held at Burghley each year. The event is designed to recognise and encourage breeders and trainers in producing the correct type of young horse that is considered to be the best material to make a top eventing horse.

The class is open to 4 and 5 year olds and the competition is divided into four sections with a different judge for each section.

A qualifying heat is judged on Saturday with competitors completing the first sections of the competition.

SECTION 1: DRESSAGE Judge - Miss Caroline Coleby - 25% of score

Unlike a normal dressage test the judge does not assess individual movements and the judge may stand anywhere to be able to get the best view. The judge is looking at the potential of the horse and must discount the effect of the rider. Three correct, elastic and regular gaits through a swinging back are what is sought.

SECTION 2: JUMPING Judge - Mr Neil Lavis - 25% of score

The competitors proceed straight from the dressage ring into the jumping phase with only enough time to adjust stirrup length. Again, the judge is looking for potential and normal showjumping penalties do not apply. A horse with a fence down through inexperience may score higher than a weak horse that may rattle three, but jump clear.

SECTION 3: MOVEMENT IN HAND Judge - Mr Malcolm Barns - 25% of score

The judge is looking at the conformation and movement of the horse.

SECTION 4: FINAL JUDGING Judge - Capt. Mark Phillips 25% of score

The highest placing six horses up to the end of section 3 are asked to show their paces, including the gallop, in the main arena.

YOUNG EVENT HORSE ENTRIES

NO. RIDER & OWNER	HORSE & BREEDING	BREEDER & TRAINER	SECTION				TOTAL
			1	2	3	4	
1 TRACEY DENNIS Rider	NONCHALANT Br. g. 5yo 16.3hh S: Domingly (NZ) D: Hymaane	Unknown Rider					
2 FREDY MERCAY Monica Huf	TORRENT G. St. 5yo 17hh S: Flooding D: Briget	Monica Huf Rider					
3 POSSUM RICHARDS Rider	KILDONA HURTLE Br. g. 5yo 16.3hh S: Kildona Combatant D: Kildona Inamina	J. & S. Gunn Rider					
4 JOANNE HILL Rider	THE MISTRESS Ch. m. 16.3hh S: Abel Bosan D: Edin Girl	Mrs Bervelling Rider					
5 ELIZABETH MULLHOLLAD Rider	WINDSONG BACKCHAT Ch. m. 4yo 16.3hh S: Zadkine (ITY) D: Smilatus	Unknown Rider					
6 JONATHON McLEAN R. & V. Creed	PALMERSTON DUELL REINHARDT By. St. 5yo 17.1hh S: Duell Schutz D: Revelette	R. & V. Creed Breeder.					
7 KATHY VAULES Rider	IMAGE Ch. g. 5yo 15.3hh S: Vain Pappa D: Exert	Unknown Rider					
8 ANN GAUDION Rider	ALBATROSS Br. g. 5yo 16hh S: Cobblers Cove D: Smokeless Charger	A. L. Bartolo Rider					
9 KAREN MAYS Rider	ELIGERE Br. g. 5yo 16hh S: Colorado Sobar D: Devil Girl	Trevor Mays Annette Bloom					
10 MERRAN WALLIS Rider	SIMPSON Ch. g. 5yo 16.3hh S: Zadkine D: Audie's Secret	Laurie Morgan Peter Jenkyn					
11 LEAH BURTON Rider	CARNIVAL TIME By. g. 5yo 16.1hh S: Pegs Sovereign (NZ) D: Marcus Belle	Unknown Rider					
12 MARK GRIFFITHS Mark & Mrs E. Griffiths	MR WONG						
13 SALLY BOYLE Rider	DARIEN POWERS G. g. 4yo 17hh S: Christophil D: Throughbred Mare	Peter Barry Rider					
14 RUSSELL JOHNSTONE V. & T. Cubley	TORLEA CORVETTE Ch. m. 4yo 16.3hh S: Valuta D: Gypsey Rowsley	V. & T. Cubley Rider					
15 CATHY KALAB Leonie Turner	SIR EDWARD OF ASHLEIGH G. g. 4yo 16.2 ¹ / ₂ hh S: Ashleigh Brigadier D: Sarah (TB)	C. & J Gronn Leonie Turner					
16 SARAH CRAWFORD Rider	MAGICIAN By. g. 5yo 16.1hh S: War Chest D: Time Setta						
17 VANESSA ROWE Sheryl Chambers	MARKSMAN Br. g. 5yo 16.1hh S: Red Gunn D: Markita	Sheryl Chambers Breeder					
18 CAROLINE QUILTY Rider	SELF ADDRESSED Ch. g. 5yo 16.2hh S: Palaban D: Saint Teppo	Tom Sutherland Rider					
19 VIVIANNE AXTON Rider	MONT SALVAT Ch. g. 5yo 16.2hh S: My Mount D: Chantelle	Lyn Hodson Rider					
20 DAWN McDOWELL Rider	THATS MINE By. g. 5yo 16.2hh S: Hot Tropic D: Denim & Lace	Dawn McDowell Breeder					
21 TANYA WERNER Rider	KOOLARA FINESSE Br. m. 4yo 16.1hh S: Kilof McOhl D: Touche (TB)	S. Gugger Rider					
22 MICHAEL HOWES Rider	GLOBALITE Ch. g. 5yo 16.1hh S: Mandane D: Miss Ardock	Unkown Rider					
23 DELWYN OGILVY Tracey Perrott	DELAMORE DIPLOMAT By. g. 5yo 16.1hh S: Comeram (FR) D: Lucky Bean (FR)	Unknown Rider					

WHY THE REAL MEN FROM SNOWY RIVER WEAR THE REAL DRIZA-BONE.



It's dark and bitterly cold and the rain is bucketing down. Your tractor's bogged and you're trying to drag stock to safety under your own steam.

The last thing you need right now is a coat that leaks.

Or one that cramps your movements because the maker has skimped on fabric to save money.

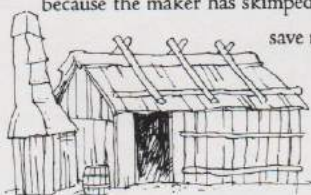

But these are just a couple of the vital differences between a copy and a genuine Driza-Bone. And they're some of the things you won't discover in a shop.

You need to be out working to appreciate why a real Driza-Bone performs so much better than a coat designed for Pitt or Collins Street farmers, or itinerant movie stars.

The real Driza-Bone, as worn by

the real mountain men, had its genesis in the sailing ships that barrelled their way to Australia along the Roaring Forties.

Andrew Le Roy, an enterprising Scot, discovered that the ships' sails could be made into excellent wet weather gear, and they proved so efficient they were soon adopted by the colony's squatters and settlers.

The early linseed oil process has been replaced along the way with a more effective Driza-Bone oiling process which stops cracking and prevents the coats from going hard and stiff. It also stops them deteriorating when they're stored during hot summers.

With a genuine Driza-Bone the rain doesn't run into your boots.

And the fabric breathes, so you don't get wet from the inside out.

In fact the fabric, the cut of the cape, and the cotton lining, all work to prevent body heat condensation - a very uncomfortable, personal greenhouse effect.

Importantly, the fabric across the back and shoulders of a Driza-Bone is cut wide enough to allow you full freedom of movement.

Sleeves are

extra long and the reinforced elbow patches are strategically placed on the inside of the elbow, preventing the pools of water that naturally form there from seeping in.

And because Australian rain is often accompanied by G-force winds, the leg straps and front closure flap are designed to stop your Driza-Bone from taking off. All these reasons make it worth your while to go for a genuine Driza-Bone. They now come in two weights, the traditional and a lighter premium weight.

If you'd like to know more about the Driza-Bone range or your nearest stockist, call this toll free number (008) 773 800.

Incidentally, every Driza-Bone is made in the knowledge that real life's much tougher than the movies.



DRIZA-BONE®
The legend of the bush.

INTRODUCTION TO HORSE TRIALS

Wandin Park Horse Trials is a One Day Event. In the world of eventing there are also Two Day and Three Day events.

There are three phases of competition in a One Day Event: Dressage, Cross Country and Showjumping, each requiring skills of thorough training, precision and boldness.

The horse must demonstrate the controlled discipline of the dressage test, yet be bold and possess the stamina to jump over 20 fences across 3km of the cross country course. He must then be able to show sufficient suppleness after the endurance test to complete a showjumping round cleanly.

The entire competition is scored on a penalty point basis with the horse and rider scoring the lowest number of penalty points winning the competition.

There are three different "classes" or levels of competition at Wandin Park Horse Trials.

The classes are:

RESTRICTED NOVICE
NOVICE
ADVANCED

The class entered depends on the horse's past performance with performance or grading points being accumulated with each placing in a competition. This ensures that horses with similar performances compete against each other.

DRESSAGE

The dressage test, lasting approximately seven minutes, is conducted on Saturday although a demonstration will be conducted in the main arena by Cherie Edmonds on Sunday at 1.00 pm and 4.20 pm.

In the Dressage test a series of set movements are executed and each one is marked by the judges, together with marks for general performance. During the dressage test, the judges look for the horse to move eagerly and energetically forward whilst remaining responsive to the rider's direction.

The dressage test is ridden in an arena 60 x 20 metres and the test must be executed from memory.

DRESSAGE TESTS

Restricted Novice:	EFA Test 1.5
Novice:	EFA Test 2.6
Advanced:	EFA Test 3.6

The penalty points incurred in the dressage are carried forward to the cross country and showjumping phases.

CROSS COUNTRY

Wandin Park has three separate courses, one for each section of competition. There are 20 fences in the Restricted Novice, 22 in the Novice, and 24 in the Advanced section. Penalties can be incurred in a number of ways.

PENALTIES:

1st refusal, run out or circle of horse at a jump	20 penalties
2nd refusal, run out or circle of horse at same jump	40 penalties

3rd refusal, run out or circle of horse at same jump	Elimination
Fall of horse and/or rider at jump	60 penalties
Third fall of horse, and/or rider at obstacle	Elimination
Error of course not rectified	Elimination
Omission of obstacle or boundary flag	Elimination
Re-taking of an obstacle already jumped	Elimination
Jumping obstacle in wrong order	Elimination
For every commenced period of 1 second in excess of time allowed	.4 penalty
Exceeding the time limit	Elimination

Competitors in the Novice and Advanced sections must carry 75kg in the cross country phase.

What is a refusal?

A horse is considered to have a refusal if it stops in front of the obstacle to be jumped. A stop, followed immediately by a standing jump, is not penalised. The horse may step sideways but if the horse steps back even a single pace, voluntarily or not, or if the halt is prolonged, this constitutes a refusal.

If a horse that has already stepped back once, is re-presented at the obstacle and halts or steps back a second time, or if the halt is prolonged and the competitor redoubles or changes his effort, still without success, this constitutes a second refusal and so on.

SHOWJUMPING

The jumping tests consists of one round with obstacles no higher than:

Restricted Novice:	1.15m
Novice:	1.15m
Advanced	1.20m

The test must be carried out at the following speeds

Advanced:	400mpm
Novice:	350mpm
Restricted Novice:	300mpm

Penalties have been changed effective 1st January 1989, and are now as follows:

PENALTIES:

First disobedience	10 penalties
Knocking down an obstacle	5 penalties
Second disobedience in the whole test	20 penalties
Third disobedience in the whole test	Elimination
First fall of horse and rider	30 penalties
Second fall of horse or rider	Elimination
Error of course not rectified	Elimination
Retaking an obstacle already jumped	Elimination
Jumping obstacle in wrong order	Elimination
For every commenced second in excess of the time allowed	.25 penalties
Exceeding the time limit (which is twice the time allowed)	Elimination

RESTRICTED NOVICE CROSS COUNTRY commences 8.45am

- | | |
|----|----------------------|
| 15 | STREETS TRIPLE TREAT |
| 16 | PROSPECTORS CAMP |
| 17 | DISCOVERY DROP |
| 18 | LAND ROVER LAKE |
| 19 | LAND ROVER LAKE |
| 20 | PICNIC TABLE |
| 21 | GARDEN CITY SPREAD |

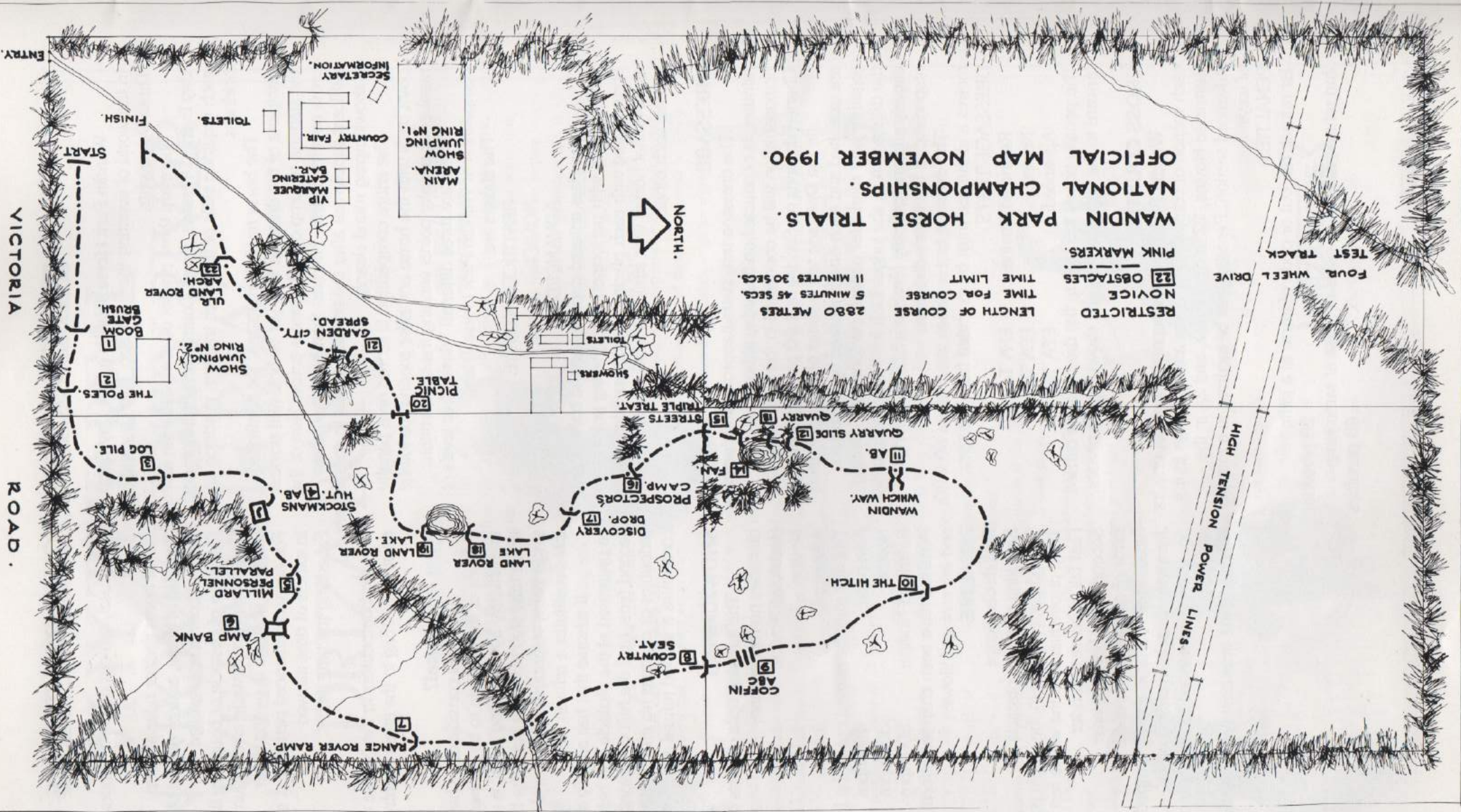

NOVICE CROSS COUNTRY commences 3pm

- ① BOOM GATE
- ② STEEPLECHASE BRUSH
- ③ LOG PILE
- ④ ABC STOCKMAN'S HUT
- ⑤ AMP BANK
- ⑥ AMADEUS ALTERNATIVE
- ⑦ SKI JUMP

- ⑧ SLEEPER WALL
- ⑨ THE TROUGHS
- ⑩ HOT SHOT BOUNCE
- ⑪ WANDIN WHICH WAY
- ⑫ WANDIN WHICH WAY
- ⑬ PERRIER BAR
- ⑭ QUARRY SLIDE

- ⑮ THE FAN
- ⑯ STREETS TRIPLE TREAT
- ⑰ PROSPECTORS CAMP
- ⑱ ABC SUNKEN ROAD
- ⑲ ABC LAND ROVER LAKE
- ⑳ TRAKEHNER
- ㉑ SHEEP FEEDER

- ㉒ ULR LAND ROVER ARCH

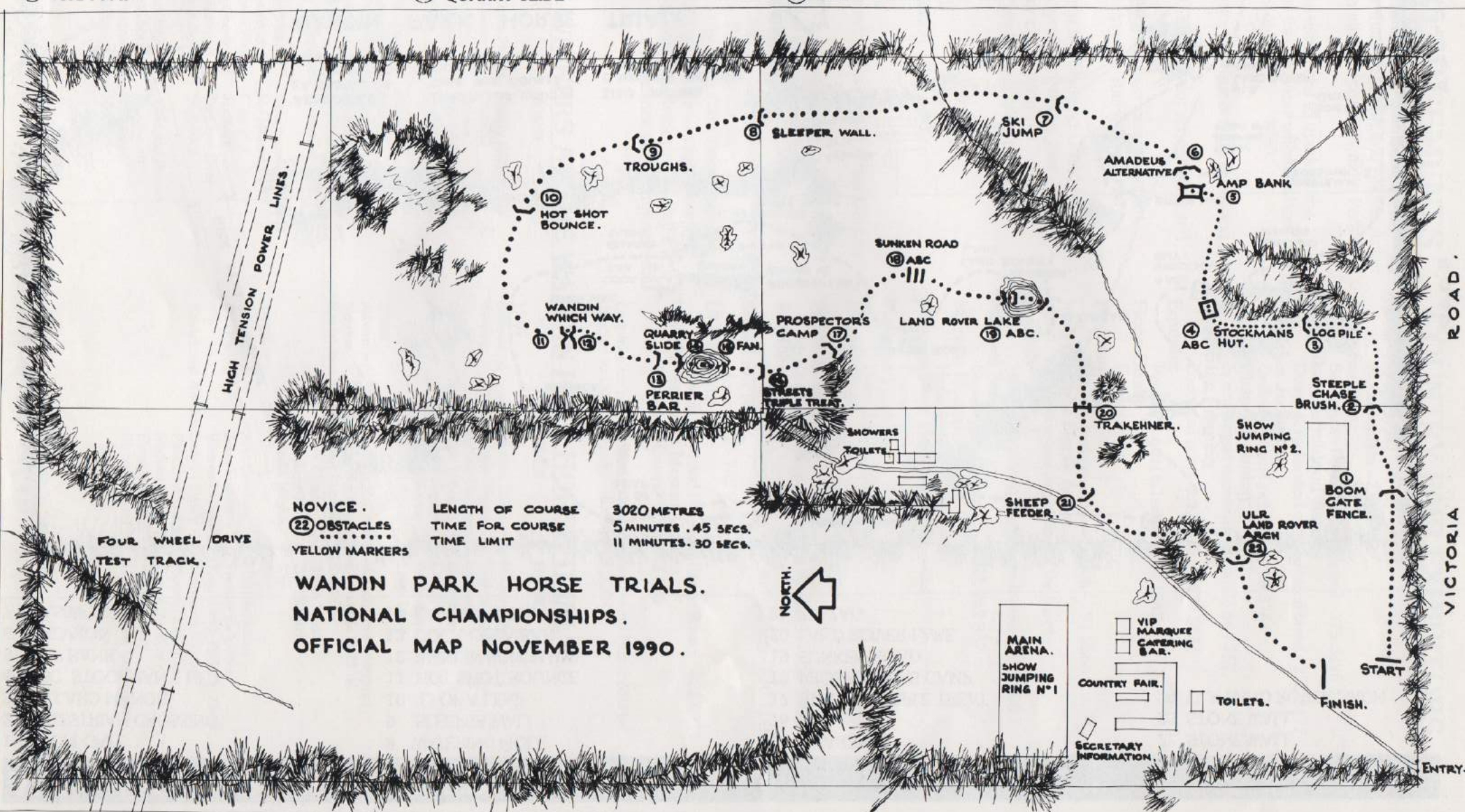

ADVANCED CROSS COUNTRY commences 1.30pm

- 1 BOOM GATE
- 2 PEDESTRIAN CROSSING
- 3 MILLARD MANOR
- 4 ABC STOCKMAN'S HUT
- 5 AMP BANK
- 6 CHEVRON
- 7 MASSIF OXER
- 8 WATERING HOLE
- 9 SLEEPER WALL
- 10 'L' OF A LEAP
- 11 HOT SHOT BOUNCE
- 12 WANDIN WHICH WAY
- 13 COCA-COLA BAR
- 14 QUARRY SLIDE
- 15 QUARRY
- 16 FAN
- 17 STREETS TRIPLE TREAT
- 18 PROSPECTORS CAMP
- 19 SUNKEN ROAD
- 20 LAND ROVER LAKE
- 21 ZIG ZAG
- 22 STONE WALL
- 23 STONE WALL
- 24 ULR LAND ROVER ARCH

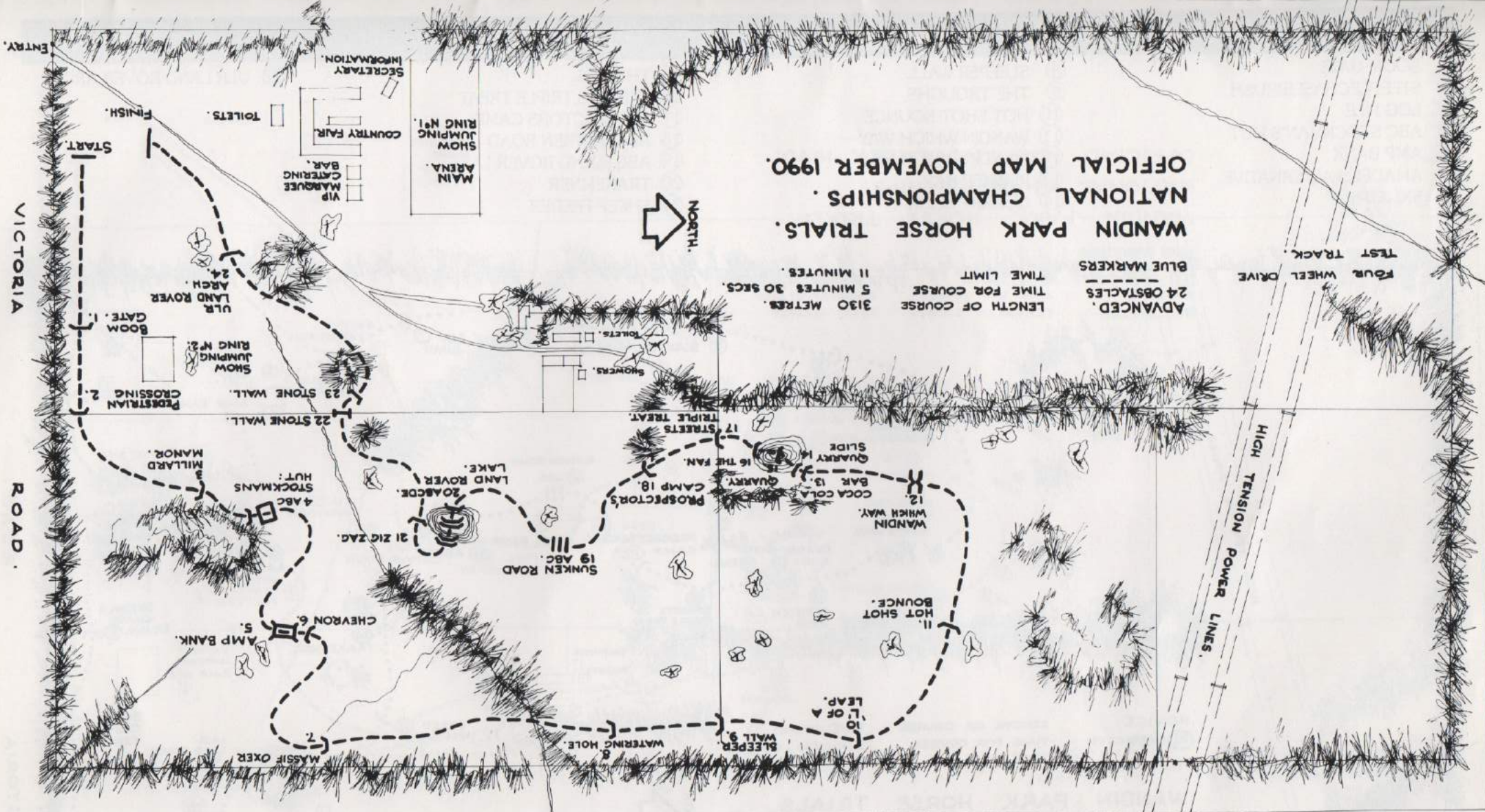

ACKNOWLEDGEMENTS

The Wandin Park Horse Trials Committee gratefully express their thanks to John and Angela Anker for the use of their beautiful property "Wandin Park".

The committee would like to thank all the people who have given their services without whom the event would not be possible:

*ULR MOTORS as major sponsor and for supplying great assistance

*ROVER GROUP AUSTRALIA for sponsorship and assistance

*Gary Brill and John Ayre for their personal effort.

*Saddle-Up for sponsoring the Young Event Horse Trophy.

*7-Eleven for sponsoring the Shetland Grand National.

*Lions Club of Mt. Evelyn for manning gate

*Seville Fire Brigade for car parking

The following companies for supplying prizes:

Equimec

Joseph Lyddy

Hy-Gain Feeds

Domaine Chandon

Horseland

Vivid Products

*Mr Max Wilson for drawing the plan of Cross Country Course.

*Stringybark Nurseries for providing plants.

*Ringwood Pony Club for loan of brick wall

*Shire of Lilydale for use of caravan

*Yarra Valley Harness Club

*Charlotte Pedersen for Dressage display

*Ernie Hicks for organising Pony Club Teams races

*Wandin Park Adult Riding Club for working bees

*Members of K.C.C. for Non-Slip Retrieving display

*Bill Penrose of K Trials for assistance with computerised scoring

COUNTRY FAIR EXHIBITORS

Amanda Lithgow

Horse portraits - 739 1763

Ascot Saddlery

Saddlery and quality riding apparel - 375 3126

Australian Warmblood Assoc.

Details & registration of Warmblood breed - 758 3177

Buckskin Jodhpurs

Quilted vests and jodhpurs - 728 3761

Cherry Picture Framing

Specialising in equestrian art - (059) 644 757

Equestrian Framing

Equestrian prints and Framing - 470 5534

Equimec

Parasite control in horses - 844 1342

Fiona Doake

Equestrian Art

Hayman Reese

Hitches, towbars and towing aids - 791 2566

Irish Draught Horse Assoc.

Promotion and registration of the breed.

K-Trials

Horse trials scoring computer software - 719 7468

Michael Steen

Showjumping equipment - (057) 942 367

Moreau Floats

Horse floats - (053) 358 807

Parsons High Plains

Horse rugs - 439 9807

Pegasus Floats

Horse floats - 720 3353

Project Hope

Horse care and rescue - 434 4859

Pro-Ride Surfaces

Dressage menage design and installation - 800 2562

Saddle - Up

Country clothing, riding wear and saddlery - 870 1146

Skye Park Rugs

Horse Rugs - 782 2703

ULR Motors

New & used Land Rovers & Range Rovers - 822 0211

Wandin Saw and Mower Centre

Saws and Mowers - (059) 643 989

Enquiries for participation in next year's Country Fair should be directed to Denis Conway (059) 643 200 (P)

PAST WINNERS AT THE WANDIN PARK HORSE TRIALS

	RIDER	HORSE
1983		
Novice	Capt. Mark Phillips	County Kildare
Restricted Novice	Diana Pearce	Churchill
	Jennifer Walsh	Grenda
	Kerrie Dawson	Star Jubilee
	K. Wood	Bordeaux
1984		
Intermediate	Brian Schrapel	Kemble
Novice	Ros Symons	Jatarra
	Helen Crombie	Tambo Wombat
Restricted Novice	Ruth Roberts	Bush Remedy
	Peter Fell	Circle 'J' Jason
	Mandy Buckerfield	Illowra Currency
1985		
Intermediate	Richard Mitton	Larapinga Roustabout
Novice	Vivienne Axton	My Muscat
Restricted Novice	Catherine Wallace	C'est Moi
	Perrin Gooding	Jindivick
	Brian Schrapel	Trial and Error
	Margaret Baker	Shabooya
1986		
Advanced	Michael Johnson	Gold and Brown
Restricted Novice	Amanda Mitchell	Sir Chisum
	Sara Jackson	Cimmarou
	Vicki Dolheguy	Maestro

	RIDER	HORSE
1987		
Advanced	Michael Baker	Nostradamus
Novice	Angela Nippers	Mighty Express
	Wendy Denholm	Balerno
Restricted Novice	Kate Wilson	Magistrate
	Donna Hayson	Cail
	Michell Taylor	Wintersun
	Michael Baker	Leigh Laird
1988		
Advanced	Andrew McLean	Woodmount Enterprise
Novice	Kerry Buckland	Carronvale Multi Bill
Restricted Novice	Stuart Buntine	Carwidya
	Julia Gibson	Kibah Medal
	Robyn Brown	Bold Regent
	Narelle Hughan	Xen
1989		
Advanced	Ann Gaudion	High Ambition
Novice	John Francis	Freddie Fudpucka
	Warren Lampard	Koombahla Park Op Shop
Restricted Novice	Delwyn Ogilvy	Diamonds Victoria
	Paul Buckland	Moorak Indiamba
	Michael Baker	Out of the Blue
	Daralyn Hodge	High Country
	Rhonda Board	Leintwardine Condamine

CARRIAGE DRIVING CHAMPIONSHIP

In conjunction with Wandin Park Horse Trials, a Combined Driving Event will be staged on Saturday and Sunday.

A Combined Driving Event consists of three elements of competition.

Competition A -

Presentation and Dressage - Saturday

Competition B -

Marathon - Sunday

Competition C

Obstacle Driving - Saturday

Presentation: The object of Presentation is to judge the turnout cleanliness, general condition of the horses, driver, grooms, harness and vehicle. Whilst it does not resemble a Show Turnout Class in minute attention to detail, the neatness and efficiency of all personnel should be taken into account and their dress should conform to the style of vehicle and harness.

Dressage: The object of the Dressage is to judge the freedom, regularity of paces, harmony and lightness, ease of movement, impulsion and correct positioning of horses on the move.

The competitor will also be judged on his style of driving, accuracy and general command of his horse. Driver must carry his whip in hand. Multiples must carry a groom, singles, optional.

Obstacle Driving (Cone Driving): This part of the competition is designed to test the fitness, obedience and suppleness of the horse and skill of the driver. The combination are timed from the first part of the horse crossing the start and finish lines.

Marathon: This phase of the competition will start at 9.30 AM on Sunday. It will test the fitness and stamina of the horse.

The marathon course is divided into five sections: A, C and E are completed at the trot. Sections B and D must be executed at the walk. At the end of Section B and D there is a 10 minute halt and also at D, a vet check. Section E includes 5 Marathon Obstacles or Hazards.

SECTION A	-	10 KM TROT
SECTION B	-	1 KM WALK
SECTION C	-	4 KM TROT
SECTION D	-	1 KM WALK
SECTION E	-	5.5 KM TROT WITH
5 HAZARDS		

For enquiries about Carriage Driving, contact
Cynthia Martin
Secretary
Yarra Valley Harness Driving Club
Tel: (059) 652 261 (AH)

CLASS 1 - PONY 11 hh & under

1. Joy Xanthos Rosette Park Little Token

CLASS 3 NOVICE PONY 14 hh & under

2. Rosemary Griffiths Rohan Luminous

3. Vicki Fromhold Jarosite Quail

4. Debra Hatton Maregyn Misha

5. Caroline Wiseman Kahlua

6. Tom Russell Ebony

7. Alan Farmer Makari Laddie

CLASS 4 NOVICE HORSE OVER 14 hh

8. Mathew Donohue

9. Robyn Banner

10. Paul Ket Charlie

CLASS 5 OPEN PONY 14 hh & under

11. Michelle Thill Rocky McMahon

12. Lindsay Campbell Jessie

13. Julie Madden Dalriada Glen

CLASS 6 OPEN HORSE OVER 14 hh

14. Ann Robertson Fera

15. Kevin Tyson

16. Peter Hennel Bundaberg

CLASS 7 PAIR PONIES

17. Gerald Barnard-Brown Echo

Quiz

Pepper

Mandy

18. Dorothy Mitchell Glenway Royal Jade

Glenway Benjamin

19. Tina Hennel Checkmate Cameriste

Checkmate Ambassador

CLASS 12 TEAMS - HORSES

20. Michael Thill Dennis

Lilly

Thomo

Marsh

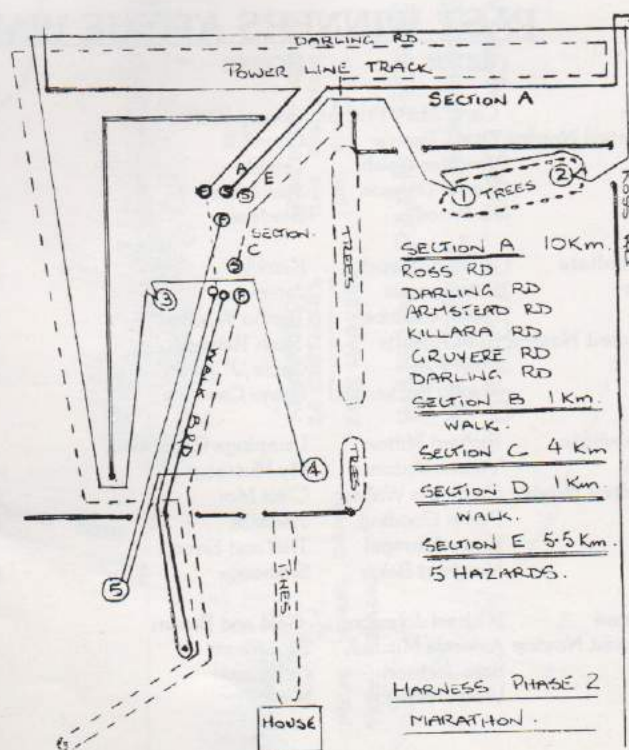

**PRELIMINARY
NOTICE**

diana ferrari
FOOTWEAR

DRESSAGE CLASSIC

SATURDAY 23rd/SUNDAY 24th MARCH, 1991

* Enjoy a wonderful weekend with top Grand Prix riders warming up for 1992 International Competition, Yarra Valley wines, international food and free entertainment.

EVENTS & TIMES

SATURDAY

- 9.30am: • Intermediate II Indoors.
- Advanced 5B & 5D championship. Outdoors.
- 1.30pm: • Grand Prix. Indoors.
- 4.30pm: • Official Opening. Cocktail party.

SUNDAY

- 10.30am: • Prix St. George Freestyle. Indoors.
- 1.30pm: • Grand Prix Freestyle. Indoors.

* Both the above events feature competitors performing a choreographed routine of required movements, put to music and judged both on technical and artistic merit.

- 4.00pm: Official closing ceremony.

Conducted by:
Glenbrae Equestrian Centre
Victoria Road, Wandin, Victoria.

Enquiries Phone:
Mrs K. Kirkhope: (03) 836 0193
Mr B. Milne: (059) 64 4493

* Top prize money on all events with \$1000. 1st prize for the Grand Prix Freestyle. EFA Rules apply.



ULR ♦ LANDROVER
WANDIN PARK
 HORSE TRIALS

CROSS COUNTRY FENCES 1990

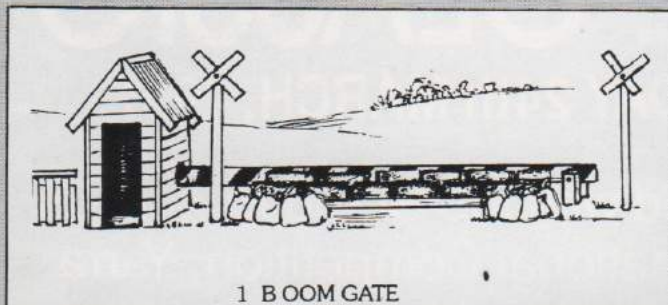

1 BOOM GATE



6 CHEVRON

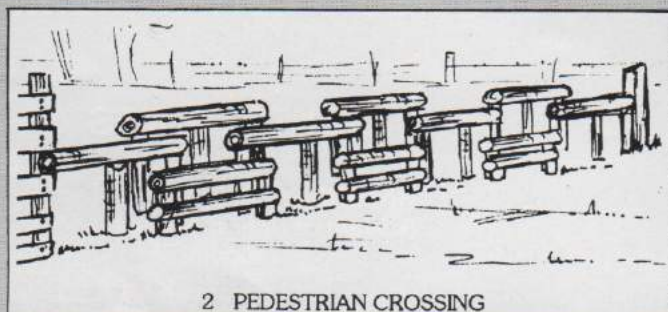

2 PEDESTRIAN CROSSING

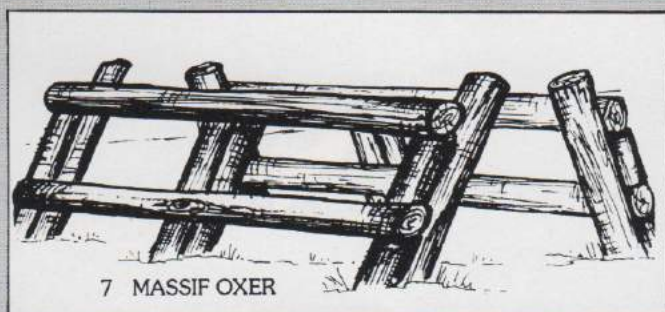

7 MASSIF OXER

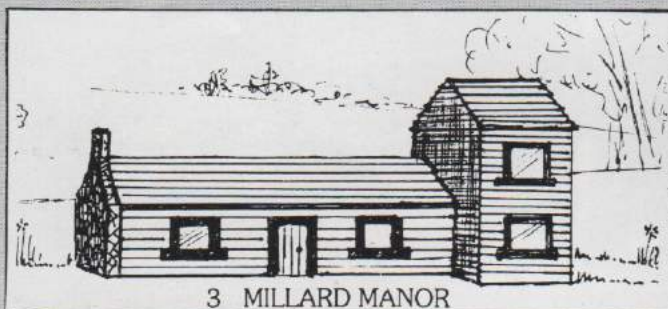

3 MILLARD MANOR

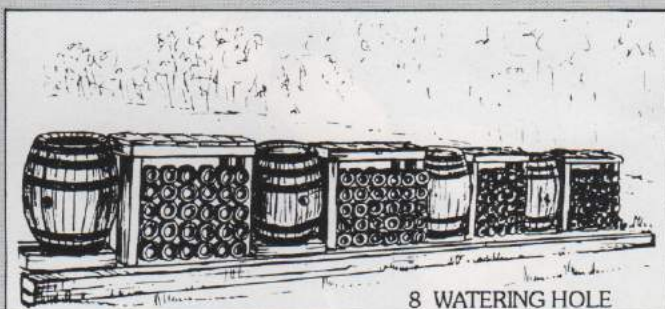

8 WATERING HOLE



4 ABC STOCKMAN'S HUT

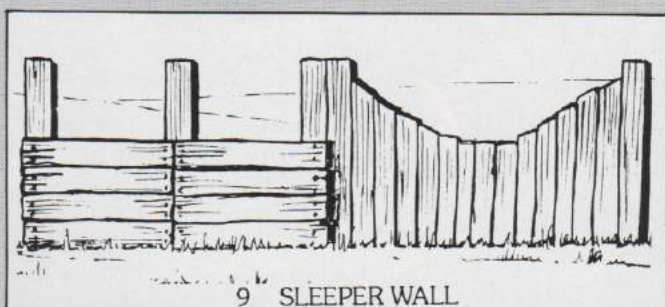

9 SLEEPER WALL



5 AMP BANK

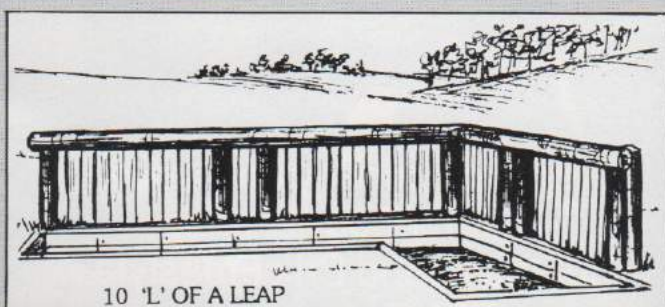

10 'L' OF A LEAP

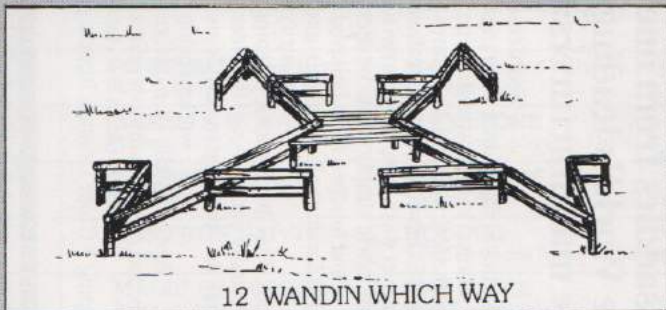

12 WANDIN WHICH WAY

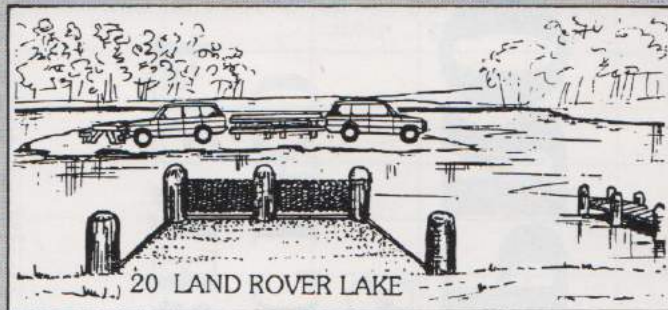

20 LAND ROVER LAKE

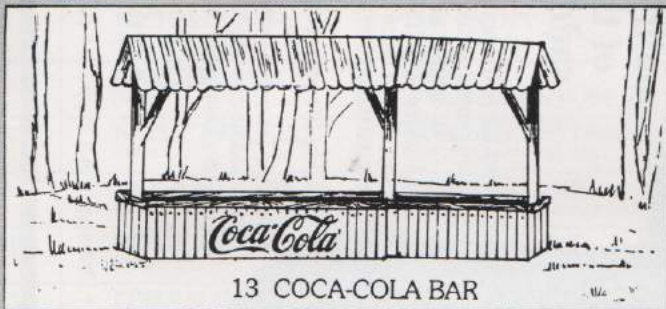

13 COCA-COLA BAR



22 STONE WALL

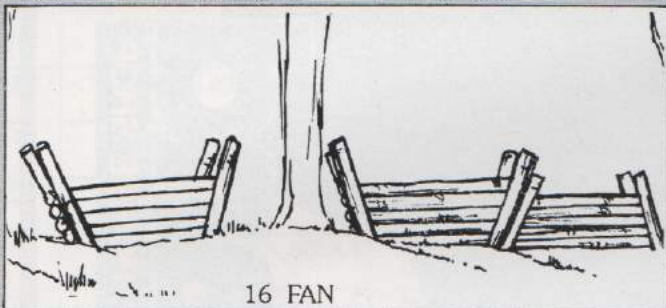

16 FAN



24 ULR LAND ROVER ARCH

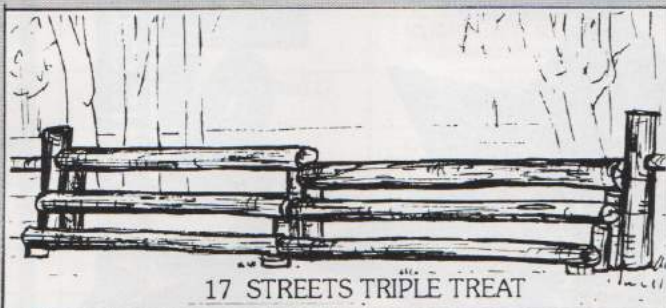

17 STREETS TRIPLE TREAT



5 - RN. MILLARD PERSONNEL PARALLEL



18 PROSPECTORS CAMP

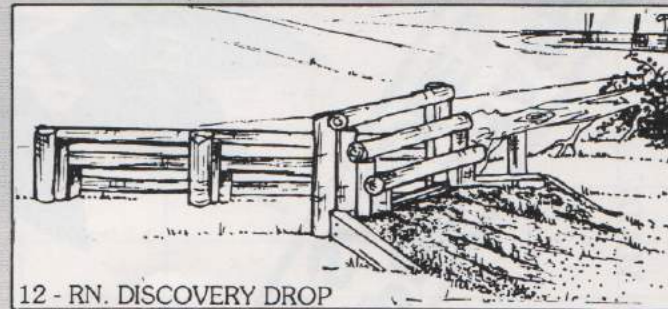

12 - RN. DISCOVERY DROP



19 SUNKEN ROAD

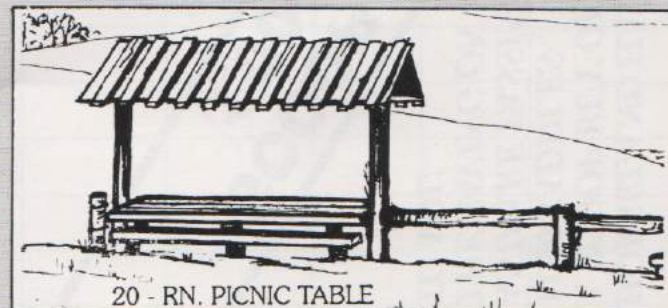

20 - RN. PICNIC TABLE

**HORSELAND HAVE MADE
A SCOOP BUY OF
1,000 SADDLES
AND ARE PASSING
THE SAVING ON
TO YOU**

**SCOOP PURCHASE
1,000 SADDLES**

**SPECIAL
OFFER**

\$499

NORMALLY

\$795

**OFFER EXPIRES
DEC. 31st 1990**

WINTEC PRO

**1,000 RIDERS
TO BE IN WINTEC PRO
BEFORE DECEMBER 31st**



**An exciting range of
quality saddles from one
of the World's leading
saddle manufacturers.**

Features:

Whilst individual saddles in the Wintec Pro range have special features tailored to their specific type, all saddles share the following basic features:

- Unique 'EQUISUEDE' fabric is equal to leather in durability yet washable, but otherwise maintenance free, this fabric simply has to be seen and touched to be believed.
 - Long life high tech tree for unrivalled stability and security.
 - Suitable for use with Wintec Flexible System, meaning that a saddle can be individually set up to suit the rider.
 - Five Year Guarantee on tree & 2 years on materials and workmanship.
 - Proven saddle skirt design.
 - Strengthened girth attachment points.
- Available in 4 styles:**
- Dressage • All Purpose • Jumping • Close Contact Jumping



Ringwood (03) 879 2988
158 Maroondah Hwy

RESTRICTED NOVICE SECTION 1- RING 1

NO.	NAME & OWNER	HORSE & BREEDING	DRESSAGE	SHOWJUMP	CROSS COUNTRY JUMP	COUNTRY TIME	TOTAL	PLACE
1	MURRAY LAMPERD R & C Lamperd	KOOMBAHLA'S PRIVATE PARTY (b.g. 6yo 17h)						
2	NARELLE MCKAY Rider	THEREFORE S:Cerreto (c.g.5yo 16.2h)						
3	MICHAEL HOWES Kim Wiffen	GHAZEPORE S:Venus & Mars (br.g.5yo 16.2h)						
4	CAMERON WHYTE Rider	HOUDINI S:On The Brink (br.g.8yo 16.2h)						
5	MAUREEN SOMMERS Rider	IJAZ RAJEE (g.m. 8yo 16.2h)						
6	MICHELLE IVILL Rider	THE ENTITY S: Oh Hello (c.g.7yo 16h)						
7	DANIELLE FARLEY Rider	SIMBA S: Zamir (c.g. 8yo 15.2h)						
8	KATHY MINCHIN Rider	STAGECOACH TRADITION S: B.J. (b.m.9yo 15.1h)						
9	ANTHONY CLAY Rider	NAMBURRI LAD S:Castle Carey (c.m.6yo 16.3h)						
10	KEITH SMITH Rider	BALMORAL ALF S:Balmoral Boy (c.g.8yo 16.2h)						
11	FERGUS CAMERON A.A. Milne	ORTHODOX S:In The Purple (br.g.12yo16.2)						
12	CATHY KALAB Rider	BARCARDI RUM (pal.g. 11yo 16.1h)						
13	JANENE ATKINS Rider	COOL LUKE (br.g. 8yo 16.3h)						
14	MEREDITH ASHTON Rider	JORDEN S:Hicockalorum (b.g.aged 15.3h)						
15	CAROLE JACOBS Rider	NIMBIAN S: Swift Ghost (g.m.12yo 16.2h)						
16	CHRISTOPHER BRUCE Rider	CAMPBELL (c.g.14yo 15.3h)						
17	DARREN BERECRY Rider	WINE LORD S:Pelopides (br.g. 7yo 16.3h)						
18	JOANNE HINTON Rider	RUMOUR'S REIGN S: Wolverton (b/br.g.8yo16.2h)						
19	JODIE FITZGERALD Jane Heritage	MORRISONS MAXAMILLION S: Fechter (b.g.11yo 16.3h)						
20	SEAN COOPER Rider	CURRAJAH CASSIUS S:Cassius Deck (b.g. 6yo 16h)						
21	ANGELA KOGGE Rider	TEXAS (b.g. 11yo 16.2h)						
22	RICHARD MITTON R.Mitton&A.Grittith	TRADE AGREEMENT S:Walgud (b.g. 7yo 16.3h)						
23	SALLY ANDREWS Rider	KENTUCKY S: Aurilandy (bl.g.7yo 17.1h)						
24	SALLY HOWE Rider	SHAZZAR (c.g. 12yo 15.2h)						
25	VIVIEN GRANT Rider	PRINCE REGENT S: Sovereignty (c.g. 9yo 16.1h)						
26	STUART SMITH Rider	MICHIGAN S: Suizu (NZ) (c.m.12yo 16.2h)						
27	BOB SCARBOROUGH Rider	KAKADU (bl.g. 10yo 16.1h)						
28	MICHELLE TAYLOR Rider	OUT OF THE BLUE (b.g. 7yo 16.2h)						
29	SHAYLEEN BLAYNEY FM & S Blayney	MALIK S: Kenmark (b.g. 8yo 16.1h)						
30	MICHELLE ANDERSON Rider	CHEZ COOL S:Coolalinga (b.g. 9yo 16h)						
31	HEATHER BOWERS Rider	MIAMI VICE S: My Cue (b.g. 9yo 15.3h)						
32	VICTORIA KENNEDY Rider	SIGHTSEER (c.g. 7yo 15.2h)						
33	JENNY WALL Rider	PALAPA S:Faffindale (g.g.8yo 16.2h)						
34	TONY BLANCHARD Rider	COOMA S: Arnhem (br.g.10yo 16.3h)						
35	CHRISTIE KIMPTON Charles Kimpton	OSCAR S:CherrymountBS(c.g.12yo15.3h)						

THE DIFFERENCE BETWEEN HORSE OWNERS AND HORSE LOVERS.

Introducing new 'EQUIMEC'® (ivermectin). The most complete parasite control agent for horses available in Australia.

For a number of years, leading horsemen and women in America and New Zealand have had the advantage of ivermectin. That advantage is now available to Australian horse lovers.

EQUIMEC contains ivermectin, a totally new type of parasiticide.

Now all your horses can benefit from today's most complete parasite control. It can prevent one of the major causes of verminous colic and delivers reliable control of all significant internal parasites, bots and summer sores. You can be confident of its performance. One tube can treat up to six hundred kilograms of body-weight. It is easy to use, doesn't clog, or go hard in the tube, and is quick and easy to dispense, which makes treatment easier on your horses.

The technical superiority of EQUIMEC is scientifically based.

EQUIMEC is registered for the treatment and control of roundworms (including arterial larval stages of Strongylus vulgaris and benzimidazole-resistant small strongyles), bots and skin lesions caused by Habronema and Draschia spp. (summer sores) and Onchocerca spp. microfilariae (cutaneous onchocerciasis).

It is the most advanced anthelmintic drug for horses available in Australia. It is now available throughout the country. If finishing well is what matters to you, don't be a late starter. Use EQUIMEC in a regular equine parasite control programme.

Equimec® (ivermectin)
FOR A FINISH THAT'S WORTH FRAMING.

MSD AGVET Division of Merck, Sharp & Dohme (Australia) Pty. Limited, South Geelong, NSW 2142
® EQUIMEC is a registered trademark of Merck & Co. Inc., Rahway, New Jersey, U.S.A.
© Merck & Co. Inc., 1986. All rights reserved.

You can't take the strain out of hard work...

but you can give
your horse that
extra relief after
the event with

EQUINADE OIL LINIMENT

An aid in the relief of pain
from Shin Soreness,
Muscular Strain,
Rheumatism and
Tendon Sprain.

All the EQUINADE products
are made in Australia, of the
finest ingredients by
experienced horsemen.
Why take the risk on
high priced imports?

EQUINADE

the name Australian
horsemen and women
know and trust.



TRADE ENQUIRIES

VIC: (03) 720 5000 NSW: (02) 683 5266
QLD: (07) 262 2114 SA: (08) 289 1211
TAS: (003) 342 211 WA: (09) 277 6122

NEW FROM EQUINADE

RESTRICTED NOVICE SECTION 2 - RING 2

NO.	NAME & OWNER	HORSE & BREEDING	DRESSAGE	SHOWJUMP	CROSS COUNTRY		TOTAL	PLACE
					JUMP	TIME		
36	RUSSELL JOHNSTONE C. Wallace	FAME OF WONDAREE S: Satu Besar (g.s.10yo16.2h)						
37	DENNIS BALL Sharon Fraser	TANAMEE (c.g. 11yo 16.2h)						
38	WARREN LAMPERD R & V Lamperd	KOOMBAHLA'S NIC NAC (g.g.)						
39	ROBIN OAKLEY Rider	BETTER SCORE S: Better Boy (b.g.15yo 16.2h)						
40	SUZY WITHERS Rider	COURCHEVAL S: Fury's Order (c.g.8yo 16.3h)						
41	TRACEY NEAL Sarah Clark	GLENFIELD FLEUR S: Boss Cockle (g.m.9yo 15.2h)						
42	NINA CLARKE Rider	PRIVATE TALENT S: Talent Beau (bl.m.9yo 16.1h)						
43	KAREN WEBBER A. McLaren	SUPERMAC S: Egmont (g.g. 9yo 16.3h)						
44	SARAH SMITH Rider	STIRLING AMBER S: Targo (c.m. 9yo 15.2h)						
45	SUSANNA THOMAS Rider	JARRAH KING (c.g. 9yo 16h)						
46	GEORGINA TAYLOR Rider	BAY GAMBLER S: Star Rocket (b.g.7yo 15h)						
47	SUE WHYTE P.Glennen & S. Whyte	SUNLIGHT BEAU S:Sunlight Beau(b.g.11yo16.2h)						
48	JENNY O'SULLIVAN Rider	RIPALONG S: Reckless (br.g. 6yo 16h)						
49	ALICIA DARVALL Rider	MADOROMA MAHRANI S:Sindilight (c.g. 16yo 16.2h)						HC
50	KRISTEN DE GROOT Rider	ZIPFIRE S:PlaudtTwister (d.g.7yo15.3h)						
51	ANDREA TURNER Rider	WHYDIDYU S: Mon Vin (c.m. 8yo 16.3h)						
52	FIONA CRAWFORD Rider	RIMINI PARK CASSIDY S:Prfinzen (br.g. 7yo 16.2h)						
53	JULIA DOWER Rider	AVRON S: Nareeb (c.g. 13yo 16.1h)						
54	JENNY ALGIE Rider	ANGLO ACHIEVE S: Nicolo (b.g. 10yo 16h)						
55	CAMERON HARRIS Rider	LINDWALL S: Old Crony (br.g.6yo 16.2h)						
56	DELWYN HOCKING Rider	SOUFFLE S: Blue Silver (g.m. 9yo 16.1h)						
57	BRYAN CURNOW Mr & Mrs B Curnow	JUST BOW (b.g. 10yo 16.2h)						
58	AMANDA CHARMAN Rider	SONNETAR S:State Occasion (g.g.9yo16.2h)						
59	STEPHEN FERGUSON Rider	DONEGAL CASTLE (bl.g. 12yo 16.2h)						
60	RHONDA MASON Rider	PYKE'S LANE (NZ) S: Riverton (c.g. 11yo 16h)						
61	JULIE KELSO Rider	BOGLE S: Setting Sun (g.g. 9yo 16h)						
62	MARK BURNELL Rider	LUMPY S: Larko (GB) (c.g.13yo 16.1h)						
63	SHARON AMOS A & W Yole	CHIRNSIDE RECADO S: Justiciero (g.m. 11yo16.2h)						
64	STEVE ISAM Rider	SAN QUENTIN KAMAHL S:K.Rch.Flinders (br.g.12yo15h)						
65	JAMES SCANLON Mrs.C. Wallace	SYRINX OF WONDAREE S:Satu Bezar (g.m.8yo 17h)						
66	KEN HAMMET Rider	WEATHERTOP MORGIGH S:RaiseA Dancer (br.g.8yo16.2h)						
67	SHANE MONTEITH Wendy Kelly	COUNT COOL (c.g. 8yo 16.2h)						
68	HELEN GARVEY Rider	NEVADA NARCISSUS S:Nevada Chief (b.g.15yo 15.3h)						
69	KIM JACOBSON Rider	DAISY S: Sterling King (b.m.11yo 16h)						
70	CAROLINE CURNOW Rider	JUST HOSS (g.g. 8yo 15.2h)						



MILLARD
PERSONNEL

Specialists in solving your search and selection requirements

- Contract
- Temporary
- Permanent

Phone: (03) 723 6444

Fax: (03) 723 6070

- | | |
|--------------------|----------------------|
| •Engineering | •Secretarial |
| •Drafting | •Data Processing |
| •Planning | •Administration |
| •Industrial Design | •Sales and Marketing |
| •Cad/Cam | •Executive |

MILLARD PERSONNEL

337 Maroondah Hwy, Croydon. Victoria.

RESTRICTED NOVICE SECTION 3 - RING 3

NO.	NAME & OWNER	HORSE & BREEDING	DRESSAGE	SHOWJUMP	CROSS COUNTRY JUMP	TIME	TOTAL	PLACE
71	IAN BALFOUR Mr & Mrs Ian Balfour	SO SILLY S: So Sharp (b.g. 9yo 15.3h)						
72	KATE ROBERTS Mrs J Rangott	RAGGERDY ANN S: Applauding (c.m. 10yo 16h)						
73	STEPHEN WEIR Rider	CONCORDE S: Swift Ghost (g.g. 7yo 16.1h)						
74	OOPY KIMPTON Charles Kimpton	HONEY DRIPPER S: Rakes Progress (c.g. 7yo 16.2h)						
75	DELWYN OGILVY Tracey Perrott	DELAMORE DIPLOMAT S: Comeram (b.g. 5yo 16.1h)						
76	BILL CHRISANIS P & S Kenny	TOUCH OF ELEGANCE S: Imperial Court (b.m. 5yo 15.1h)						
77	RICHARD MITTON Rider	NAME THE PLACE S: Pride of Place (g.g. 6yo 16.1h)						
78	KARALYN MCDONALD Rider	CHABLIS (b.m. 16.1h)						
79	SUE HEMINGWAY Rider	OMEJO JACK (b.g. 10yo 16h)						
80	TRUDI YATES Rider	SHOSHONE PARK TUSCORORA S: Ngawyni (c.g. 7yo 16.3h)						
81	DEBRA ROLLASON Rider	MIDNIGHT OIL S: Vengeance (br.g. 10yo 16h)						
82	ANNA SAVAGE Rider	PUCK (c.g. 7yo 15.3h)						
83	NICOLE ROUGET Rider	SPYCATCHER (c.g. 10yo 16.2h)						
84	NICOLE CRAIG Rider	MALABARD S: Bardall (c.g. 13yo 16.1h)						
85	NIGEL BERRY N & M Berry	ILLOWRA SKYE						
86	GEORGINA FOX Rider	BARCLAY'S TOM DOOLEY (c.g. 13yo 15.3h)						
87	TRISH LACEY Rider	SMOOTH OPERATOR S: Shah Rule (c.m. 9yo 16.1h)						
88	LYNETTE DICKIE Rider	HICKORY (c.g. 15yo 16h)						
89	LISA WADDELL Rider	JUNIOR KING S: B'field Brz King (g.g. 8yo 16h)						
90	JOHN HOY Rider	CODY (b.m. 9yo 15.3h)						
91	KERRY SISELY Rider	OUT BACK JACK (c.m. 6yo 16.2h)						
92	ANGELA NIPPERS Rider	ADLOO BENJAMIN S: L.A. Dragon (b.g. 5yo 16.3h)						
93	KATHY VOWLES Rider	IMAGE S: Vain Pappa (c.g. 5yo 15.3h)						
94	MARK GRIFFITHS Rider	HOSUN S: Horbury (b.g. 9yo 16.3h)						
95	JUDI ORAM-KRANTZ Rider	MR JACKSON S: Lord of Dance (b.g. 9yo 16.2h)						
96	CATHRYN BREWSTER Rider	SIR SHILOH (buck.g. 10yo 15.2h)						
97	MARION MCLEISH Rider	CONISTON S: Good & True (c.g. 8yo 16.1h)						
98	ROBYN BROWN Rider	JUST A DAZ S: Gentle Jack (b.g. 6yo 16.1h)						
99	SAMANTHA GASKIN Anne Bray	GALWAY (b.g. 11yo 16.3h)						
100	PHILIP JACOBS P & C Jacobs	AMARNI S: Taj Rossi (c.m. 6yo 16.1h)						
101	LEE TURNER Anthony Clay	MAGIC DRAW S: Grey Baron (b.m. 10yo 16.3h)						
102	LYNDEN SKEELS Rider	ISLE OF MCKAY (b.g. 10yo 16.2h)						
103	ANNE PUTKER A & A Putker	TANGALORE S: Nicklesilver (g.m. 8yo 15.1h)						
104	LISA MONTEITH Rider	ALI S: Magnesa (g.g. 7yo 16.1h)						



D O M A I N E
C H A N D O N



HOT SHOTS®

BARBECUE - FUEL

Proud to be a sponsor of the
Wandin Park Horse Trials 1990

Victoria Road, Wandin North

RESTRICTED NOVICE SECTION 4 - RING 4

NO.	NAME & OWNER	HORSE & BREEDING	DRESSAGE	SHOWJUMP	CROSS COUNTRY JUMP	TIME	TOTAL	PLACE
105	CHRIS HOLIAN Rider	BRITTAIN S:Crowned Point (br.m.10yo16.3)						
106	SUE HOWARD Chelsea Howard	MY SOVEREIGN (c.g. aged 15.1h)						
107	SHARON BUNTING Rider	SILVERBRIDGE TRISTRAM S:Connemarra P.R.(g.g.11yo17h)						
108	MICHAEL HOCKING Rider	SWIFT S:Alpha Two (br.g.10yo 16h)						
109	DEBBIE WILLIAMS B & D Williams	RAINBOW CHASER S: Talent Beau (br.g.10yo 17h)						
110	ROONIE WEEKS Rider	FASHION (c.g. 9yo 16.2h)						
111	GILLIAN CURRY Rider	FLINT OF STEEL S: Plutus (c.m. 7yo 16h)						
112	JENNY WALL Rider	NEARLY FAMOUS S:Arch Sculptor (b.g.9yo 15.3h)						
113	LINDA COLE Rider	KARU S:Rowston Major (g.g.8yo 16.2h)						
114	TONY BLANCHARD Mrs N Butterworth	WILLOWBANK EVITA S: Esenada (br.m.12yo 15.3h)						
115	SARAH NEVILE SJ & SS Nevile	SMART REMARK (c.g. 6yo 16.1h)						
116	MURRAY LAMPERD R & C Lamperd	BRANIGAN'S PRIDE (g.st. 5yo 16.3h)						
117	CHRISTINE BURY Rider	HASTINGS (g.g. 9yo 15.3h)						
118	NARELLE HOGG Rider	LENTARA SPECIAL CHOICE S:L.Moon Fashion (b.g.9yo15.1h)						
119	TINA COCKAYNE Rider	REDGUM S: Telethon (c.g. 8yo 16h)						
120	ANNE BAKKER Jack Priestley	SILVERFAX						
121	DANIELLE LITTLEJOHN Rider	BONA FIDE S: Strobe (g.g. 8yo 15.2h)						
122	PAUL SEUREN Rider	ROCKAWAY S:Flyingfan (c.g. 12yo 16.3h)						
123	PHILIPPA DOAKE Rider	AFRICAN BAY S: Bold Flip (br.g.6yo 16.1h)						
124	MICHELLE COTTON Rider	MISTER B S: Celsius (b.g. 10yo 16.1h)						
125	BRIAN SCHRAPEL A.Uytendaal & Rider	BOONGARRY S:Always Welcome (c.g. 6yo 17h)						
126	EMMA CLACY Rider	MANGO S:Count Redwin (c.g. 7yo 16.2h)						
127	SARAH INGLIS Rider	MONSOON S: Monopol (b.g. 10yo 16h)						
128	PENNY MOLNAR Rider	THE PINK PANTHER S: No Mercy (bl.g. 7yo 16h)						
129	CARMEL SORRAGHAN Rider	BENZARK (bl.g. 16.1h)						
130	COLLEEN GADSBY Clifford Gadsby	LUSATIA PARK REX S: Fechter (b.g. 10yo 15.2h)						
131	GILLIAN CANAPINI Rider	DARJEELING S: Sepoy (b.m. 7yo 16h)						
132	MELISSA ANDERSON Rider	OMEGA'S GOLD SON S:Elgin Downs (pal.m.11yo15.1h)						
133	JODI BACON Rider	RED CURIOSITY S: Rashamon (c.g. 6yo 16h)						
134	LINDA BALFOUR Mr & Mrs Ian Balfour	AZARA MISTRAL S:Iraki Rahman (g.g. 6yo 16h)						
135	NICKY NASH Rider	IRISH BLUE S: Falneur (g.g. 8yo 16.3h)						
136	KATIE CALVERT Rider	KIBAH PLAYBOY S: Big Hat (br.g. 9yo 16.1h)						
137	RUTH LINNANE Rider	GOLDEN EDITION S:Communique'(c.g.7yo 16.1h)						
138	MELANIE CHARLES Rider	CHRISSHANE S: BetterLad (b.m.14yo 16h)						

Dazzle the Judges as well as the Spectators



Joseph Lyddy The brand name you can trust, Tried and proven since 1893

WAPROO PTY LTD 315 Canterbury Road, Victoria Phone: (03) 836 0277

Enjoy
Coca-Cola
TRADE MARK REGD.
Coke
TRADE MARK REGD.

RESTRICTED NOVICE SECTION 5 - RING 5

NO.	NAME & OWNER	HORSE & BREEDING	DRESSAGE	SHOWJUMP	CROSS JUMP	COUNTRY TIME	TOTAL	PLACE
139	ANGELA NIPPERS Rider	MELBA S:Noble Charger(c.m.5yo 16.2h)						
140	KAY HARDING Rider	JIRIMA TIMELY LAD S: Small Time (c.g. 12yo 16h)						
141	KIM SLAVIN Rider	DARING AUSSIE S: Darascem (c.g. 8yo 17h)						
142	MERRAN WALLIS Rider	EDWARD BEAR S: Certainly Sir (br.g.6yo 15.3h)						
143	DIANA SHARLAND Rider	COLUMBARD S: So Bar (c.g. 16.1h)						
144	HEATHER BOWERS Rider	PERNO S: Mironton (b.g. 10yo 16.3h)						
145	VICTORIA KENNEDY Rider	PENOLA ORION S:P.Bold Borderer (br.g.12yo 15h)						
146	STUART BUNTINE Mrs J Whitehead	SPRINGCREEK ALCAZABER S: Granad (b.g. 8yo 16.1h)						
147	GILLIAN ELWES Rider	MILLBANK S:Blessington (b.g. 7yo 16.2h)						
148	KYLIE WAKE Rider	ST. GEORGE S:Sts.& Sinners (g.g.5yo 16.3h)						
149	DESLIE GILICK Rider	KHMER ROUGE (c.g. 7yo 15.2h)						
150	JAN KENNAN Rider	NIKSAR S: Game Siksar (br.g. 10yo 16h)						
151	TRACEY NEAL Rider	ELANOR S:Clever Coup (g.m. 5yo 16.2h)						
152	STEPHEN FERGUSON Rider	TERRAE FILLIUS S: Terraminta (c.g. 6yo 16h)						
153	JAMES SCANLON Miss B Scanlon	RECKLESS MANNER S: Reckless (b.g. 9yo 16.2h)						
154	ANGELA RAMSAY Rider	TAGA MAGO S:Peev'y Apache (b.g.8yo 16h)						
155	MELINDA LITTLEJOHN Rider	A TOUCH OF BRILLIANCE (c.g. 8yo 15.1h)						
156	JENNY BERRYMAN Rider	O'FLAHERTY S:Auk(USA)(br.g.10yo 16.2h)						
157	NEVA BRUNNING Rider	SILVER ECLIPSE (g.g. 10yo 15.3h)						
158	TRISH JONES Rider	TAM S: Sir Wilks (br.m.13yo 15.2h)						
159	DAVID COLLINS Rider	QUIET ACHIEVER S:Imperial Taunie (b.g.12yo 16h)						
160	ANDREW MCLEAN Rider	WOODMOUNT KINETIC S: Jukebox (br.g. 7yo 16.1h)					SCRATCHED	
161	MANDY TRIMBOLI Rider	MR SHOWTIME S:Staninsky (b.g. 16h)						
162	NINA CLARKE Rider	OPPORTUNITY KNOCKS S: Alterego (c.g. 7yo 16.1h)						
163	PHILIPPA RAND Rider	CLAUDIUS (br.g. 8yo 16.2h)						
164	DOMINIC COOK Rider	AQUA VITE S: Anguston (br.m. 12yo 16.1h)						
165	BRUCE MILNE Rider	MAHOMAD (g.g. 8yo 16.3h)						
166	SAM SEMENIUK Rider	JAHEMELLA S: Jaheel (g.m. 10yo 14.3h)						
167	CELIA BRAY Rider	DEEPPDALE SUNDANCE S:Medora T'Winds (c.g.6yo 16.1h)						
168	NORM CLARK Rider	HISORSE (c.g. 6yo 16h)						
169	IAN BALFOUR Mr & Mrs Ian Balfour	OUTLAW S: Nindabarri (c.g. 9yo 15.2h)						
170	LISA WADDELL Rider	TONY BARLOW EDITION S:Final Chapter (b.g.10yo 16.1h)						
171	KARALYN MCDONALD Rider	DEDUCTION (c.g. 11yo 16.1h)						
172	LEANNE WILSON Rider	INDIAN CHARGER S:Noble Charger (b.g.7yo 16.2h)						



Pegasus Horse Floats



Unchallenged Excellence

For Discerning Owners

Factory 2, Lot 4 Canterbury Rd., Kilsyth.

03
— 720-3353 —

Top of the range



Country Clothing

Akubra Hats, Driza-bone, R.M. Williams Boots, Moleskins, Belts, Shirts, Swandry Bush Shirts, Thomas Cook Hats, Oilskins, Moleskins, Yakka Workgear, Blundstone Boots.

Greenfields

OPEN 7 DAYS A WEEK

Maroondah Hwy., Lilydale (1 km East of shops) Phone: 735 5722



GARDEN CITY TRANSPORT

PTY. LTD.

REFRIGERATED TRANSPORT SERVICES

Departing daily from Melbourne, Sydney, Brisbane & Adelaide

MELBOURNE DEPOT:

66 Cambria Road, Keysborough 3173

Contact: Gary Haynes - Phone (03) 701 5066 Fax: (03) 701 5033

SYDNEY DEPOT:

18 Darwin Drive, Lapstone 2773

Contact: Bill Harding - Phone (047) 39 4802 Fax: (047) 39 1568

BRISBANE DEPOT:

6 Hull Street, Thorneside 4158

Contact: Barry Watson - Phone (07) 207 5703 Fax: (07) 207 1318

NOVICE SECTION 1 - RING 6

NO.	NAME & OWNER	HORSE & BREEDING	DRESSAGE	SHOWJUMP	CROSS COUNTRY JUMP	TIME	TOTAL	PLACE
173	ELIZABETH MULHOLLAND Rider	MR WARABA S: Arise Sir (b.g. 7yo 16.2h)						
174	RHONDA BOARD Rider	DARK EDITION S: Agrifo (br.g. 9yo 16.2h)						
175	MEGAN BAKER Beverley Baker	BEAMOND CORKY S: Brennin Pur (b.g. 10yo 15h)						
176	KATE MINSTER Rider	DOUBLE DARE (b.g. 12yo 15.2h)						
177	VANESSA ROWE Rider	JOYFUL GAMBLER S: Gav Gambler (b.g. 9yo 16h)						
178	CHARLOTTE READER Rider	RYKO (b.g. 10yo 16.2h)						
179	LEIGH HOLMES Rider	JOE JO ZEP (b.g. 13yo 16.1h)						
180	CAMILLA POOLMAN Mrs M Poolman	CAMPASPE S: Familytalk (b/br/g. 10yo 15.1h)						
181	NIGEL BURNETT Rider	MCGONAGALL S: Pantry Bay (g.g. 12yo 16h)						
182	SARAH FRAYNE Rider	REPORT S: Comic Port (b.g. 11yo 16.2h)						
183	GABRIEN WITNEY Rider	ROSEMONT S: Bailvhoit (UK) (g.g. 10yo 15.2h)						
184	RUTH COPPA Rider	MEMPHIS BOY (b.g. 11yo 16.1h)						
185	MICHELLE ATKINSON Rider	RICH RETURN (g.m. 7yo 15.1h)						
186	TRICIA MOLONEY Rider	GLENCOE BONNY S: Gortland (br.m. 9yo 16h)						
187	KATE WILSON Rider & Int. Saddlery	HUBERTUS TAD S: Markland (c.g. 7yo 17h)						HC
188	OOPY KIMPTON Charles Kimpton	MR GOLDFINGER S: Na-Wak-Wa (c.g. 9yo 16.1h)						
189	ANDREW MCLEAN Rider	WOODMOUNT KINETIC S: Dukebox (br.g. 7yo 16.2h)						
190	PENNIE O'DEA Rider	HOB NOB S: Quarryknowe (g.g. 11yo 15.2h)						
191	MICHAEL HOWES Rider	NATIVE CASTLE S: Native Prince (b.g. 9yo 17h)						
192	STEPHEN WEIR Pauline Weir	WAIT-UNTIL-DARK S: Flying Gem (br.g. 9yo 16.2h)						
193	POLLY LYON (UK) R & C Lamperd	KOOMBAHLA PARK MATTAYA (b.g. 9yo 16.1h)						
194	ROSS SPALDING Rider	TIME LORD (c.g. 10yo 16.2)						
195	LUCINDA GREEN (UK) Mrs S Sullivan	KILKENNY CASTLE S: Aqua D'Oro (c.g. 7yo 16.1h)						

NOVICE SECTION 2 - RING 7

NO.	NAME & OWNER	HORSE & BREEDING	DRESSAGE	SHOWJUMP	CROSS COUNTRY JUMP	TIME	TOTAL	PLACE
196	LORRAINE WILSON Rider	TIESHAN GOLD (c.g. 14yo 16.2h)						
197	PATSY GUSSENHOVEN Rider	JOCULARITY S: Box Valley B'dict (b.g. 9yo)						
198	DANIEL WILSON Rider	BOLD EVENTER S: Shadoof (b.g. 10yo 16.1h)						
199	SUE BARLOW Rider	BANDARRAH (br.g. 12yo 15.3h)						
200	TE-ANU HUNT Rider	ABNIKA S: Radiant Gold (c.g. 13yo 16.2h)						
201	ANTHEA SUTHERLAND Andrew Sutherland	QUINCEY QUADRUPED S: Penola B.B. (b.g. aged 16.2h)						
202	WENDY KELLY Rider	HATS AWAY S: Big Hat (g.g. 10yo 16.1h)						
203	SALLY AUSTEN Rider	MR JON JOVI S: Sizzun Trim (b.g. 8yo 17h)						
204	VICKI FOLETTA Rider	CASH S: Sou Wester (b.g. 7yo 16.2h)						
205	MATTHEW SYKES Rider	SLOANE SQUARE S: Talent Beau (bl.g. 12yo 16.3h)						
206	GREG BROWN Rider	TRES SAUVAGE S: Garlander (b.g. 9yo 16.1h)						
207	ROBERT GARDNER Rider	WELLINGTON ROAD (appaloosa m. 9yo 16h)						
208	RICHARD LANCASTER Mr N Curry	ARM OF STEEL S: Valuta (UK) (b.m. 12yo 16.2h)						
209	HUNTER DOUGHEY Rider	ON GOING S: Dazzling Dia (c.g. 6yo 16.1h)						
210	STUART BUNTINE S. Abbott	MUMPIEOWIE (b.g. 7yo 16.1h)						
211	JODI COCKAYNE Rider	BERRAGOON CLASSIC S: Pemblegong (g.g. 8yo 15.3h)						
212	PHILIP CAFARELLA Rider	TRY (g.g. 11yo 16.1h)						
213	JOANNA WILSON Rider	SONNY JIM (br.g. 15yo 15.3h)						
214	DEBBIE WILLIAMS Rider	ORIENT EXPRESS S: Hauban (bl.g. 10yo 16.3h)						
215	ROONIE WEEKS Rider	BOLLINGER S: Top Class (bl/br.g. 11yo 17h)						
216	WARREN LAMPERD Lyn Mulholland	CAPTAIN JACK S: Valuta (NZ) (br.g. 11yo 16.2h)						
217	RHONDA BOARD Audrey Morris	LEINTWARDINE CONDOMINE S: Hawa Mahal (buck.g. 11yo 15.3h)						
218	ELIZABETH MULHOLLAND Geoff Mulholland	WINDSONG SKYWAY S: Skyhigh (imp) (c.g. 5yo 16.2h)						

ADVANCED - RING 8

NO.	NAME & OWNER	HORSE & BREEDING	DRESSAGE	SHOWJUMP	CROSS COUNTRY JUMP	TIME	TOTAL	PLACE
219	MARY JANE CRABTREE Rider	BERTIE WOOSTER S:Copper Glow (br.g. 10yo 17h)						
220	MARGARET MCLEAN (NZ) Rider	ATLANTIC CITY (NZ) S:Village Sq.(b.g. 13yo 16.3h)						
221	ANDREW HOY Rider	JOE GUNDY						
222	MICHAEL BAKER Wendy Rowlands	HIGH AMBITION S:On-The-Nod (b.g. 10yo 16.2h)						
223	KEN GILLIAM Rider	MONTGOLFER (br.g. 12yo 16.1h)						
224	MICHELLE AIKEN Rider	EL TORO S: Elsalaf (c.g. 15yo 16h)						
225	DEREK PIPER Gayna Williams	AFTER THE FIRE S: Tolspring(c.g. 10yo 16.2h)						
226	LISA BLACKMAN Rider	PETRONIUS S:P.Thunderbird(b.g.15yo15.2h)						
227	ROBYN BROWN Rider	BOLD REGENT S:Soverlegnty (c.g. 8yo 16.1h)						
228	LOUISE TRELOAR Rider	HARRISON S: Jake						
229	DANIEL WILSON Miss K James	OUR WINTER S: Super Grey (g.g.11yo 16.2h)						
230	JUSTIN HOCKING A & J Hocking	BENASH S:Bending Away(b.g. 13yo 16h)						
231	SUE LESLIE Rider	NIKITA S:Safety Match(br.m.10yo16.2h)						
232	RICHARD MITTON Rider	CHARLATON S:W.C.Noon Wood(b.g. 14yo 17h)						
233	DELWYN OGILVY D.Ogilvy & L.Roberts	BETA S:Star Coree(bl/br.g.9yo16.3h)						
234	SUZETTE SEATON Rider	LADY DALRYMPLE S: Tomatin (c.m.11yo 15.3h)						
235	SARAH NEVILE Rider	LONDON TOWN S:Swift Chost (g.g.11yo 17.3h)						
236	TRICIA REWELL Rider	MR GABLE S: No Mercy (g.g.11yo 16.1h)						
237	TRUDI YATES Rider	ZULU S: Eleazer (br.g. 8yo 17h)						
238	SHARON RIDGWAY Rider	BALLYMOON CASTLE S: Altai Khan(b.g. 10yo 16.1h)						
239	MICHAEL CREBER Rider	TO BE SURE S: Clever (b.m.12yo 16.2h)						
240	GERALDINE MASON Rider	KAMAHI (c.g. 14yo 16.3h)						
241	POSSUM RICHARDS Rider	GARIBALDI S: Big Diamond (br.g.10yo 17h)						
242	SUE WOLFF Rider	MAKITA S:Lorenthus (g.g.15yo 16.1h)						
243	GREG WATSON Kerry Buckland	CARRONVALE MULTI BILL S:C'vale Meddle (c.g.10yo 17h)						
244	ANDREW HOY Rider	KIWI S: Old Solder (br.g.11yo16.2h)						
245	NARELLE HOGG Rider	LENTARA QUAHLEE S:FirstLove (UK)(br.g.7yo16.1h)						
246	NIGEL BERRY N & M Berry	SUNGI MAS S:Crash Helmet (b.m.11yo16.2h)						
247	ANNA SAVAGE JP & P Savage	JAAHL (c.g. 8yo 15.3h)						
248	BRIAN SCHRAPEL Mr A McCarthy	WALTER RALEIGH S:Indian Conquest(br.g11yo16h)						
249	MARGARET MCLEAN (NZ) Rider	RHUM S:Princely R'w (br.g.13yo16.2h)						
250	MICHAEL BAKER Mr N Humphris	IMAGE S: Hunky Pappa (g.g.12yo16.1h)						
251	IAN BALFOUR Linda Balfour	THE VAGABOND S: Nindabarri (b.g. 17yo 16h)						
252	MURRAY LAMPERD R & C Lamperd	DEVON VIEW WINTON S:D.V.Winfield (c.g. 8yo 16.1h)						

Hon. Organizer: Mr John Anker
 EFA Technical Delegate Mr Ken Jelbart
 President of Wandin Park Horse Trials Committee
 Secretary Mr Russell Withers
 Entries Secretary Mrs Glenys Clark
 Treasurer Mrs Jackie Priestley
 Publicity Mr George Mohren
 Ms Jennifer Dennis
 Ms Sue Coed
 Sponsorship Mr Russell Withers
 Mr Geoff Sinclair
 Country Fair Mrs Helen Conway
 Mr Denis Conway
 Ground Manager Mr Peers-Johnson
 Gate Mt Evelyn Lions Club
 Parking Seville Fire Brigade
 Catering Mrs Angela Anker
 Mrs Krys Graves
 Mrs Marg Brown
 Seville Pony Club
 Programme Mr Russell Withers
 Main Arena Co-ordinator Mr John Grant
 Illustrations Mrs Diane Withers
 Medical Officers Dr Michael Howe
 Dr Frank Tighe
 Red Cross
 Dr Simon Bray
 Dr Andrew Turner
 Mrs Carol Jacobs
 Mrs Jane Southorp
 Mr Charles East
 Mr Denis Conway
 Mr Bill Penrose
 Mrs Leonie Thompson
 Mr Rob Wylie
 Ms Helen Green
 First Aid
 Veterinary Officers
 Vet Assistants
 Farrier
 Chief Scorer
 Computer Scoring
 Scorers Mrs Robyn MacAuley
 Mrs Brenda Barude
 Mrs Shirley Wearne
 Mr Bill Noble

OFFICIALS

Commentators Mr Hugh Coleby
 Mr John Proper
 Mr Paul Buckland
 Mr Bill Roycroft
 Mr Ted Morley
 Mr Neil Clinton
 Ms Caroline Coleby
 Jury of Appeal
 DRESSAGE
 Co-ordinator Mrs Carol Jones
 Ground Manager Mr Philip Rosevear
 Gear Check Mrs Marj England
 Marshalls Mrs Natalie McGregor
 Miss Debbie Smith
 Judges - Advanced Mrs Glenys Shandley
 Mrs Gillian Handford
 Novice Mrs Pam Pierce
 Mrs Judy Lowe
 Mrs Anthea Cooper
 Miss Barbara Buckley
 Restricted
 Novice Mrs Kay Harris
 Mrs Margaret McKay
 Mrs Pat Brittan
 Mrs Catrina Corten
 Mrs Corinne Wilson
 CROSS COUNTRY
 Chief Steward Mr Bill Roycroft
 Assistant Stewards Mr Peter Davidson
 Mr Neil Clinton
 Capt. Mark Phillips
 Mr Frank Fitzgerald
 Mr Tony Peers-Johnson
 Mr Max Rouget
 Mr Colin Clark
 Mr Ted Morley
 Mr Ken Kneebone
 Start

Finish
 Judge Co-Ordinator Mr David Rowland
 Mr Bob Adams
 Mr Jock Fraser
 Fence Judges
 Miss Diane Bruce Mrs Raelene Lester
 Mr John Barude Mr Michael Lester
 Mrs Louise Bartlett Mr Noel Moyland
 Mr Andy Biddle Ms Nadia Manypenny
 Mr David Bailey Mrs Janette McKenzie
 Miss Debbie Coutts Ms Shelia Nairn
 Mr John Craig Mrs Keitha Raaba
 Mr Keith Steadwell Mrs Julie Hanson
 Mrs Joy Sweet Mrs Mervyn Hastings
 Mrs Kay Thomas Mrs Lyn Hammett
 Mrs Lisle Trapnell Mr Peter Hagen
 Mr Doug Trapnell Mr John Kirk
 Mr Noel Thompson Mr Allister Lascelles
 Mrs Thodes Ms Wendy Olenick
 Mrs Judy Doake Ms Liz Waters
 Ms Kim Blanche Ms Monica Cook
 Communication Mr Graham Sweet
 Bike Co-Ordinator Ian Shepherd
 SHOWJUMPING
 Designer & Builder - Ring No.1 Mr Ted Morley
 Judge Mrs Betty Morley
 Stewards Mr Ken Wiltshire
 Mr Neil McConnell
 Designer & Builder - Ring No.2
 Judge Mrs Jenny Sheppard
 Mr Ron Lewis
 Jenny Muir
 Mr David Sheppard
 Steward Showjumping equipment courtesy of the Melbourne
 Showjumping Club
 YOUNG EVENT HORSE
 Co-Ordinator Mrs Jenny Sheppard

GENERAL CONDITIONS - WANDIN PARK HORSE TRIALS

- These Horse Trials will be conducted under the E.F.A. Combined Training Rules for Horse Trials 1983 and the amendments since that date.
- LIABILITY.** Neither the Organising Committee nor the Equestrian Federation of Australia accept any liability for any accidents, damage, injury to horses, owners, riders, grooms, officials, spectators, ground or any other person or property whatsoever.
- RESERVATION.** The organisers reserve the right
 - to cancel any class or event
 - to divide any class
 - to alter the advertised times
 - to refuse any entry, with or without stating the reason
 - to alter the horse's class within its grading
 - to combine any classes.
- FORBIDDEN ASSISTANCE.** Outside assistance is forbidden, under penalty of elimination. Any intervention by a third party, whether solicited or not, with the object of facilitating the task of the rider or helping his horse, is considered forbidden assistance. Similarly it is forbidden for a competitor to join or accept a lead from another. It is forbidden for a jump judge or official to call back or assist a competitor by directions to rectify an error of course. Catching a loose horse, helping the rider to adjust his saddlery or to remount after a fall is permitted. In such a case, the course must be resumed at the exact spot at which it was interrupted. Whether or not a competitor has received forbidden assistance will be decided by the E.F.A. Steward.
- All dogs must be kept on leads at all times.
- PRESENTATION OF PRIZES.** The prizegiving will take place at the conclusion of the event. All placegetters must present themselves correctly attired and mounted for presentation of prizes.



The Horse Handbook & Diary

NEW 1991 Edition Features

- A Horseman's Alphabet with wonderful original illustrations by Arthur Horner
- Great colour photos of Australian and International Equestrian Stars
- First Aid instructions
- Competition Results Record
- Contact Telephone Numbers
- Pull out year planner
- And space to record a whole new year for you and your horse.

JUST \$20.95 POST FREE

Please rush my copy of the 1991 Horse Handbook & Diary to:

Name:

Address:

.....P'code

I enclose \$.....for.....Diary/s at \$20.95@
 POST TO: HORSE DIARY, Sporthorse International.,
 Old Gembrook Road, Pakenham Upper, VIC 3810



Washed the car lately?

For thirty-three years, we at ULR have specialised solely in Land Rover and Range Rover.

At our one location, we have a vast selection of new and used models from which to choose, plus a large fully equipped workshop with staff who will expertly attend to all your needs.

With the largest stock of spare parts and accessories anywhere in Australia, ULR is unique in its ability to offer complete sales and service for these “often imitated – never bettered” prestige marques.

So don't take the chance of being

left without a paddle – come to Victoria's only true specialists.

ULR

ULR Motors Pty Ltd. LMCT 1886. Authorised Dealers. 1339 High St., Malvern 3144 Fax. No. (03) 20 7019. For sales and service ring (03) 822 0211